

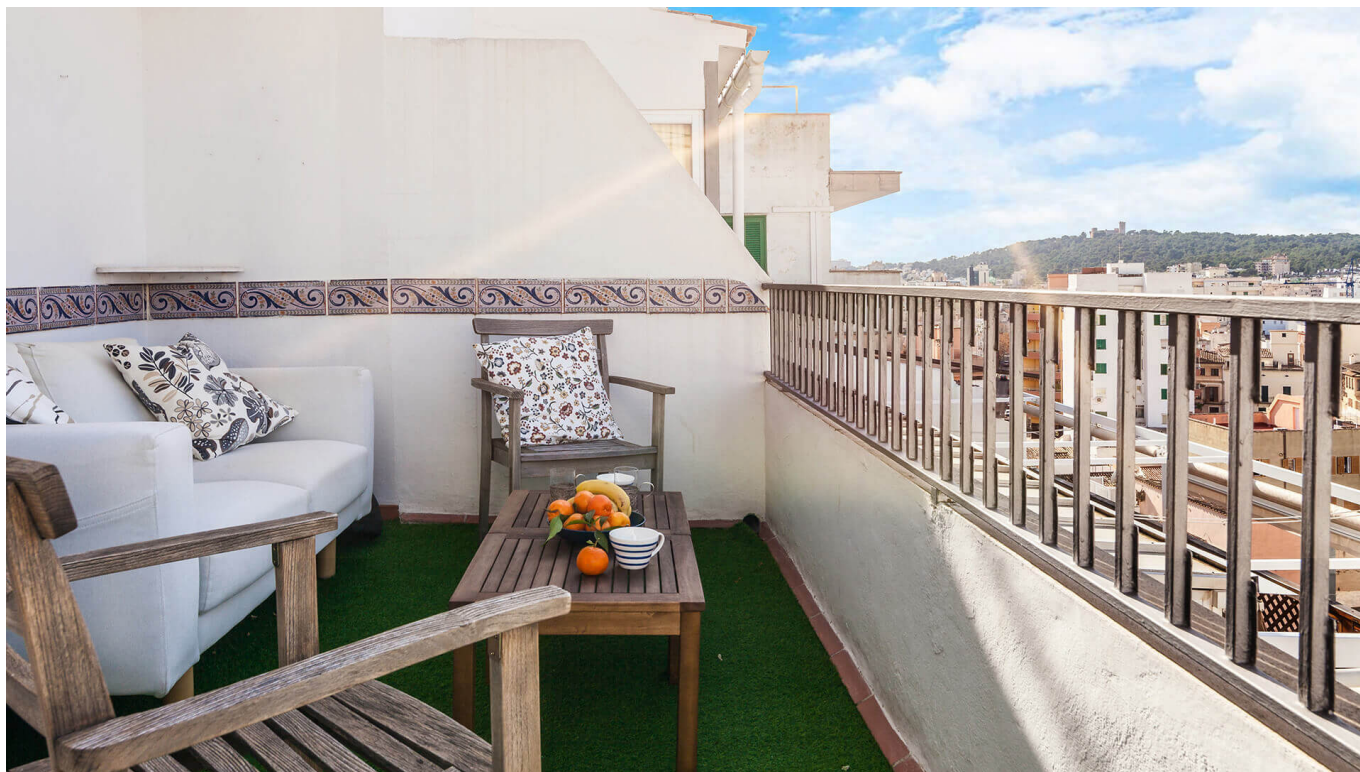

Mallorcadesidencia®  
More than a real estate agency













Ref.:MF1955

### Ático con terraza y vistas bonitas a las montañas

Este ático encantador se sitúa en un edificio con ascensor, en una parte más tranquila de Santa Catalina, aún cerca del mercado y del Club de Tennis de Palma. El area de vivienda es de 60 m2, distribuido en 2 dormitorios de buen tamaño, 1 baño, y una sala de estar soleada con una moderna cocina abierta integrada.

El piso tiene dos balcones, que pueden usarse tanto como trastero y/o para crear su propia sala exterior, con vistas bonitas sobre Palma y las montañas al fondo.

Información adicional: aire acondicionado, doble acristalamiento, ascensor, coste mensual bajo.

 Santa Catalina - Tennis	 no	 no
 2	 1	 no
 54 m2 +  13 m2	 290.000	 si





Mallorcadesidencia®  
More than a real estate agency

Ref.: MF1955

Ático con terraza y vistas bonitas a las montañas





Mallorcaresidencia®  
More than a real estate agency

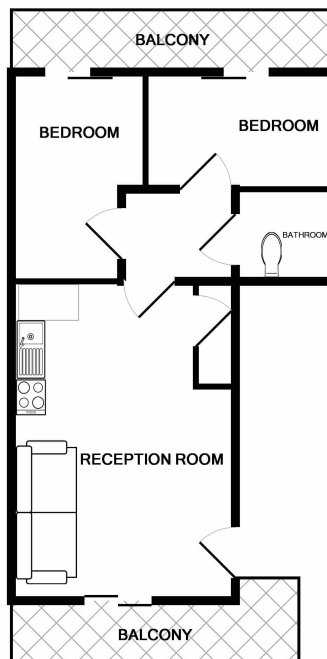

THIS FLOOR PLAN IS FOR ILLUSTRATIVE PURPOSE ONLY  
Whilst every attempt has been made to ensure the accuracy of the floor plan contained here, measurements of doors, windows, rooms and any other items are approximate and no responsibility is taken for any error, omission, or mis-statement. This plan is for illustrative purposes only and should be used as such by any prospective purchaser. The services, systems and appliances shown have not been tested and no guarantee as to their operability or efficiency can be given  
Made with Metropix ©2018