

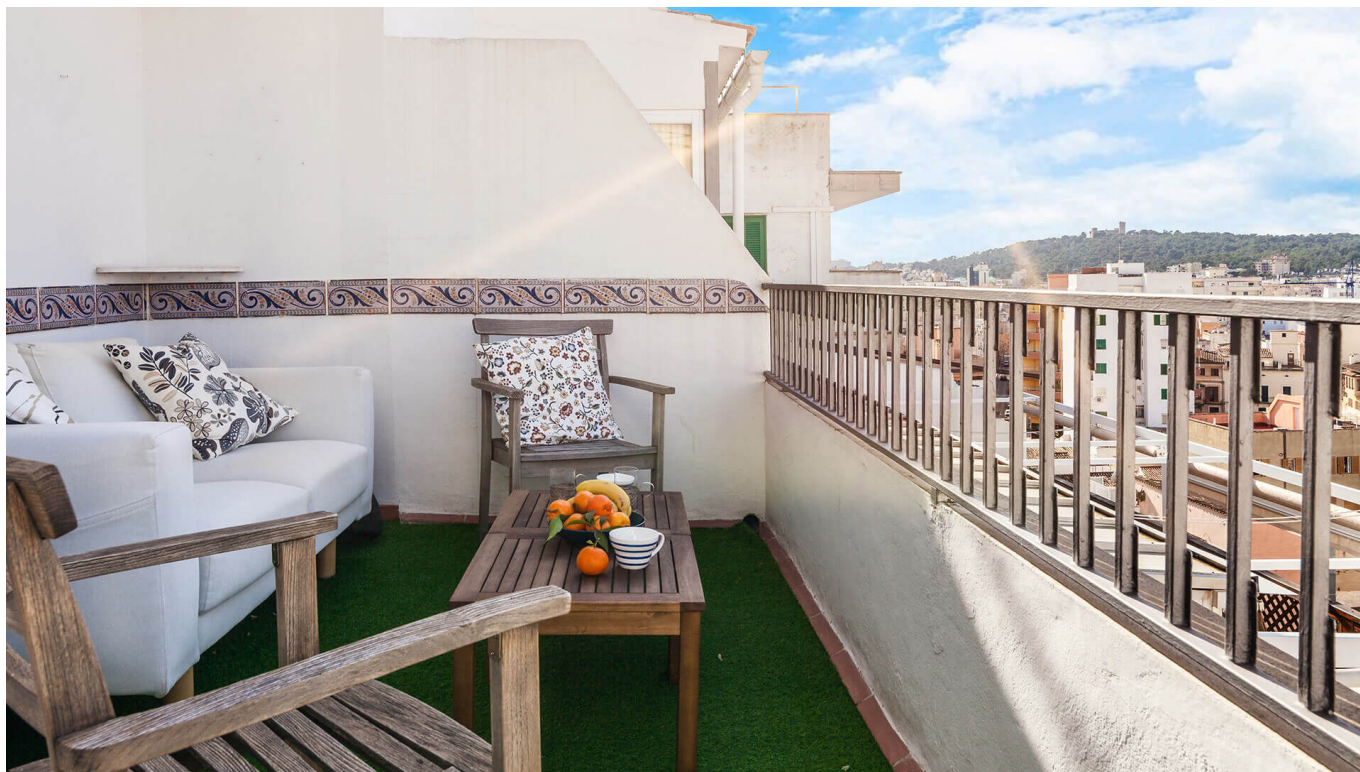

Mallorcaresidencia®
More than a real estate agency











Ref.:MF1955

Penthouse with terrace and wonderful mountain views

This charming penthouse is located in a building with elevator in a quieter area of Santa Catalina, still close to the market and to Palma Sport and Tennis Club. The living area is 60 m2, distributed in 2 good sized bedrooms, 1 bathroom, and a nice bright living room with an open modern kitchen.

The apartment enjoys 2 nice balconies that can be used both as storage and/or to design your own outdoor-living room, with beautiful views over Palma and the mountains in the background.

Additional information: Air conditioning, double glazing, elevator, low monthly fee.

	Santa Catalina - Tennis		no		no
	2		1		no
	54 m2 +  13 m2		290.000		yes





Mallorcaresidencia®
More than a real estate agency

Ref.: MF1955

Penthouse with terrace and wonderful mountain views





Mallorcaresidencia®
More than a real estate agency

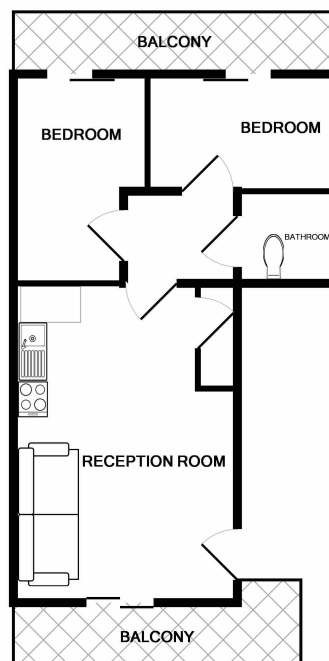

THIS FLOOR PLAN IS FOR ILLUSTRATIVE PURPOSE ONLY
Whilst every attempt has been made to ensure the accuracy of the floor plan contained here, measurements of doors, windows, rooms and any other items are approximate and no responsibility is taken for any error, omission, or mis-statement. This plan is for illustrative purposes only and should be used as such by any prospective purchaser. The services, systems and appliances shown have not been tested and no guarantee as to their operability or efficiency can be given
Made with Metropix ©2018